



Calor XHT-FT Series

XHT7000FT Datasheet

12V Front Terminal VRLA-AGM

Specifications

Voltage (Vdc)	12V
Watts Per Cell (30-Sec to 1.67VPC @25°C)	1766.00
Watts Per Cell (5-Min to 1.67VPC @25°C)	1144.17
Watts Per Cell (15-Min to 1.67VPC @25°C)	642.50
Max Charge Current (A)	58.30 (5 sec)
Max Discharge Current (A)	1550 (5 sec)
Short Circuit Current (A)	4132 (5 sec)
Internal Resistance (mΩ)	Approx. 2.01 mΩ
Terminal Type	I2 thread alloy terminal to accept M6 bolt
Terminal Torque	51.7±10.3 kgf·cm / 44.9±9.0 lbf·in 5.1±1.0 N·m
Container Material	Flame-Retardant Polymer Material (UL 94-V0)
Weight (kg. / lb.)	Approx. 50.9kg / 112.21lb
Length (L) (mm / in)	558.0 ± 2.5mm / 21.97 ± 0.10in
Width (W) (mm / in)	126.0 ± 1.5mm / 4.96 ± 0.06in
Height (H) (mm / in)	255.0 ± 2.5mm / 10.04 ± 0.10in
Design Life	12+ Years in Standby Service at 25°C; Up to 10 Years in Standby Service at 35°C
Operating Temperature	Nominal: 25°C (77°F) Discharge: -40°C - 65°C (-40°F - 149°F) Charge / Storage -40°C - 65°C (-40°F - 149°F)
Float Charging Voltage	13.5 - 13.8VDC / battery @ 25°C (77°F)
Eq. Charging Voltage	14.4 - 15.0VDC / battery @ 25°C (77°F)
Self-Discharge	Less than 10% after 90 days, can be stored up to 6 months & 10 months with equalization charge @ 25°C (77°F). Full recharge required before use. Charge sooner if stored above 25°C (77°F).



KEY FEATURES

- Valve Regulated Lead Acid (VRLA) Battery Constructed with High Durability Material (UL 94-V0)
- Maintenance-Free, Absorbent Glass Mat (AGM) Technology for Efficient Gas Recombination of up to 99%
- Pure Lead Construction and Catalyst 2X Proprietary Additive Technology

APPLICATIONS

- Designed for High-Rate & High-Temperature Standby Service
- Optimized for Harsh Environments with Extended Service Life

SAFETY & COMPLIANCE

- Built in Accordance with IEC 60896-21/22:2004
- UL1973 Listed (MH66728)
- UL1989 Recognized (MH14533)
- Certified by TUV NORD according to ISO 9001:2015



© 2026 CSB Energy Technology Co., Ltd. All Rights Reserved.

CSB Energy Technology Co., Ltd. reserves the right to change specifications or design without notice. Visit csb-battery.com for the latest information.



Calor XHT-FT Series

XHT7000FT Datasheet

12V Front Terminal VRLA-AGM

Constant Current Discharge Characteristics Per Battery: Amperes (25°C / 77°F)

F.V/Time	30SEC	60SEC	2MIN	5MIN	8MIN	10MIN	15MIN	20MIN	30MIN	45MIN	60MIN	90MIN
10.02V (1.67VPC)	944	910	876	661	526	464	353	288	209	152	118	82.7
10.50V (1.75VPC)	771	751	732	573	465	416	325	269	199	148	115	81.0
10.80V (1.80VPC)	632	614	596	502	418	372	300	249	188	142	111	78.5

Constant Power Discharge Characteristics Per Battery: Watts (25°C / 77°F)

F.V/Time	30SEC	60SEC	2MIN	5MIN	8MIN	10MIN	15MIN	20MIN	30MIN	45MIN	60MIN	90MIN
10.02V (1.67VPC)	10596	9998	8928	6865	5520	4902	3855	3191	2366	1754	1382	988
10.50V (1.75VPC)	8937	8716	7674	6030	5019	4473	3629	3006	2269	1704	1349	970
10.80V (1.80VPC)	7401	7192	6988	5474	4554	4118	3395	2814	2160	1637	1303	945

Line Drawing

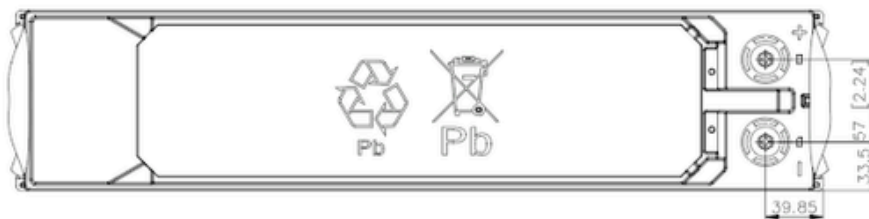

Detail A Drawing(4:1)

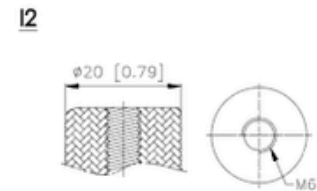

[M6 bolt]



© 2026 CSB Energy Technology Co., Ltd. All Rights Reserved.

CSB Energy Technology Co., Ltd. reserves the right to change specifications or design without notice. Visit csb-battery.com for the latest information.