

### Specifications

Voltage (Vdc)	12
Ah Capacity (8-Hr 1.75 VPC @ 25°C)	63.7
Ah Capacity (20-Hr 1.75 VPC @ 25°)	69.6
Ah Capacity (8-Hr 1.80 VPC @ 25°)	62.7
Max Charge Current (A)	18
Max Discharge Current (A)	800
Short Circuit Current (A)	1340
Internal Resistance (mΩ)	Approx. 6.27
Terminal Type	12 thread lead alloy terminal to accept M6 bolt
Terminal Torque	51.7±10.3 Kgf·cm / 44.9±9.0 Lbf·in / 5.1±1.0 N·m
Container Material	Flame Retardant ABS (UL 94-V0)
Weight (kg. / lb.)	21.20 / 46.72
Length (L) (mm / in)	280.0±2.5 / 11.02±0.09
Width (W) (mm / in)	105.0±1.5 / 4.13±0.05
Height (H) (mm / in)	260.0±2.5 / 10.23±0.09
Design Life	Up to 12 Years in Standby Service at 25°C. Eurobat (20°C): >12 Years Very Long Life
Operating Temperature	Nominal: 25°C (77°F) Discharge: -15°C - 50°C (5°F-122°F) Charge/Storage: -15°C - 40°C (5°F - 104°F)
Float Charging Voltage	13.5 - 13.8 Vdc/battery 25°C (77°F)
Eq. Charging Voltage	14.4 - 15.0 Vdc/battery 25°C (77°F)
Self-Discharge	Less than 10% after 90 days, can be stored up to 6 months at 25°C (77°F); Fully recharging is required before usage, and charged sooner if stored at higher temperature than 25°C (77°F).



Valve Regulated Lead Acid (VRLA) Battery

Maintenance-Free, Absorbent Glass Mat (AGM) Technology for Efficient Gas Recombination of up to 99%

Pure Lead Construction and Proprietary Elements

Designed for Float Service Standby Power Applications

Built in Accordance with IEC 60896-21/22:2004, UL1973 Listed (MH66728) and UL1989 Recognized (MH14533)

Certified by TUV NORD according to ISO 9001:2015



### Constant Current Discharge Characteristics Per Battery: Amperes (25°C, 77°F)

F.V/Time	15MIN	30MIN	60MIN	90MIN	2HR	3HR	4HR	5HR	6HR	8HR	10HR	20HR
10.02V (1.67VPC)	121	74.6	44.6	32.5	25.8	18.5	14.6	12.0	10.3	8.05	6.65	3.51
10.50V (1.75VPC)	110	71.2	43.7	32.1	25.5	18.3	14.4	11.8	10.2	7.96	6.58	3.48
10.80V (1.80VPC)	99.5	67.4	42.3	31.4	25.0	17.9	14.1	11.7	10.0	7.83	6.48	3.43

### Constant Power Discharge Characteristics Per Battery: Watts (25°C, 77°F)

F.V/Time	15MIN	30MIN	60MIN	90MIN	2HR	3HR	4HR	5HR	6HR	8HR	10HR	20HR
10.02V (1.67VPC)	1319	825	503	373	298	215	171	143	122	95.2	78.5	42.2
10.50V (1.75VPC)	1211	796	495	370	295	213	169	141	120	94.3	77.8	41.8
10.80V (1.80VPC)	1106	762	482	363	290	210	167	139	119	93.1	76.9	41.3

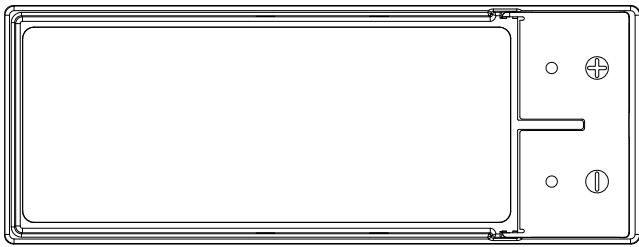

Detail A Drawing(4:1)

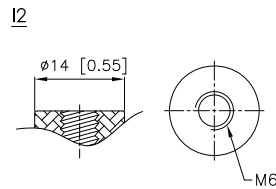

[M6 bolt]

280±2.5 [11.02±0.10]

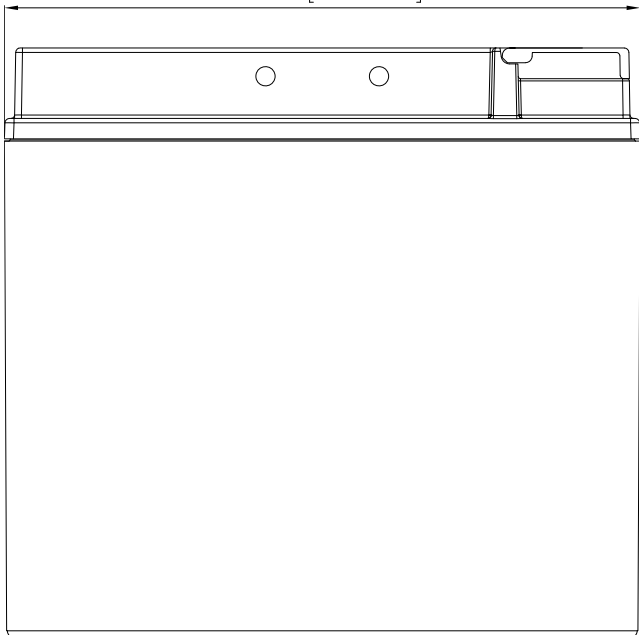

105±1.5 [4.13±0.06]

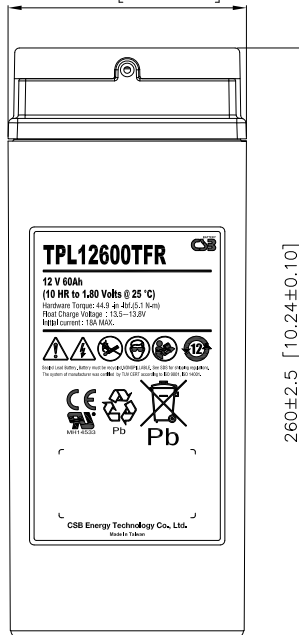

260±2.5 [10.24±0.10]