



TPL Series

TPL122000FR Datasheet

12V Front Terminal VRLA-AGM

Specifications

Voltage (Vdc)	12
Ah Capacity (8-Hr 1.75 VPC @ 25°C)	198
Ah Capacity (20-Hr 1.75 VPC @ 25°C)	214
Ah Capacity (8-Hr 1.80 VPC @ 25°C)	194
Max Charge Current (A)	60.0
Max Discharge Current (A)	1150
Short Circuit Current (A)	3093
Internal Resistance (mΩ)	Approx. 3.60
Terminal Type	I2 thread lead alloy terminal to accept M6 bolt
Terminal Torque	51.7±10.3 Kgf·cm / 44.9±9.0 Lbf·in / 5.1±1.0 N·m
Container Material	Flame Retardant ABS (UL 94-V0)
Weight (kg. / lb., Approx.)	59.70 / 131.58
Length (L) (mm / in)	560.0±2.5 / 22.05±0.10
Width (W) (mm / in)	124.0±1.5 / 4.88±0.06
Height (H) (mm / in)	323.0±2.5 / 12.72±0.10
Design Life	Up to 12 Years in Standby Service at 25°C. Eurobat (20°C): >12 Years Very Long Life
Operating Temperature	Nominal: 25°C (77°F) Discharge: -15°C - 50°C (5°F-122°F) Charge/Storage: -15°C - 40°C (5°F - 104°F)
Float Charging Voltage	13.5 - 13.8 Vdc/battery 25°C (77°F)
Eq. Charging Voltage	14.4 - 15.0 Vdc/battery 25°C (77°F)
Self-Discharge	Less than 10% after 90 days, can be stored up to 6 months at 25°C (77°F); Fully recharging is required before usage, and charged sooner if stored at higher temperature than 25°C (77°F).



Valve Regulated Lead Acid (VRLA) Battery

Maintenance-Free, Absorbent Glass Mat (AGM) Technology for Efficient Gas Recombination of up to 99%

Pure Lead Construction and Proprietary Elements

Designed for Float Service Standby Power Applications

Built in Accordance with IEC 60896-21/22:2004, UL1973 Listed (MH66728) and UL1989 Recognized (MH14533)

Certified by TUV NORD according to ISO 9001:2015





TPL Series

TPL12200FR Datasheet

12V Front Terminal VRLA-AGM

Constant Current Discharge Characteristics Per Battery: Amperes (25°C, 77°F)

F.V/Time	15MIN	30MIN	60MIN	90MIN	2HR	3HR	4HR	5HR	6HR	8HR	10HR	20HR
10.02V (1.67 VPC)	351	235	142	102.1	80.3	57.1	44.8	37.2	31.9	25.0	20.8	10.9
10.50V (1.75 VPC)	308	217	136	100.4	79.1	56.3	44.2	36.7	31.5	24.7	20.5	10.7
10.80V (1.80 VPC)	275	201	130	97.9	77.0	55.0	43.3	35.9	30.9	24.3	20.2	10.6

Constant Power Discharge Characteristics Per Battery: Watts (25°C, 77°F)

F.V/Time	15MIN	30MIN	60MIN	90MIN	2HR	3HR	4HR	5HR	6HR	8HR	10HR	20HR
10.02V (1.67 VPC)	3638	2535	1582	1178	930	665	525	437	376	296	247	126
10.50V (1.75 VPC)	3352	2386	1533	1159	915	656	518	431	371	293	244	124
10.80V (1.80 VPC)	3062	2215	1470	1124	890	641	508	424	365	289	242	123

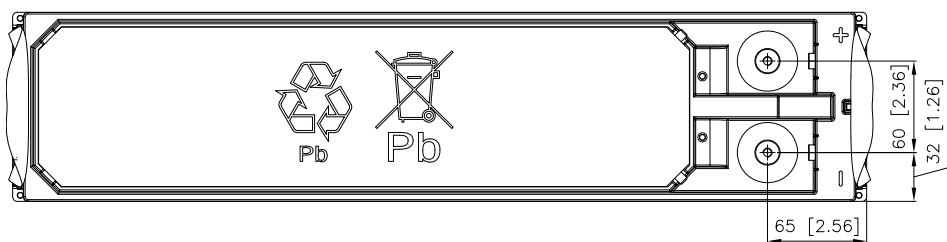

12

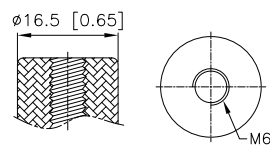

[M6 bolt]

