



TPL Series

TPL121800 Datasheet

12V Front Terminal VRLA-AGM

Specifications

Voltage (Vdc)	12
Ah Capacity (8-Hr 1.75 VPC @ 25°C)	175
Ah Capacity (20-Hr 1.75 VPC @ 25°C)	192
Ah Capacity (8-Hr 1.80 VPC @ 25°C)	172
Max Charge Current (A)	54
Max Discharge Current (A)	800
Short Circuit Current (A)	2575
Internal Resistance (mΩ)	Approx. 3.90
Terminal Type	I2 thread lead alloy terminal to accept M6 bolt
Terminal Torque	51.7±10.3 Kgf·cm / 44.9±9.0 Lbf·in / 5.1±1.0 N·m
Container Material	Flame Retardant ABS (UL 94-V0)
Weight (kg. / lb., Approx.)	55.1 / 121.44
Length (L) (mm / in)	547.0±2.5 / 21.54±0.10
Width (W) (mm / in)	124.8±1.5 / 4.94±0.06
Height (H) (mm / in)	320.3±2.5 / 12.72±0.10
Design Life	Up to 12 Years in Standby Service at 25°C. Eurobat (20°C): >12 Years Very Long Life
Operating Temperature	Nominal: 25°C (77°F) Discharge: -15°C - 50°C (5°F-122°F) Charge/Storage: -15°C - 40°C (5°F - 104°F)
Float Charging Voltage	13.5 - 13.8 Vdc/battery 25°C (77°F)
Eq. Charging Voltage	14.4 - 15.0 Vdc/battery 25°C (77°F)
Self-Discharge	Less than 10% after 90 days, can be stored up to 6 months at 25°C (77°F); Fully recharging is required before usage, and charged sooner if stored at higher temperature than 25°C (77°F).



Valve Regulated Lead Acid (VRLA) Battery

Maintenance-Free, Absorbent Glass Mat (AGM) Technology for Efficient Gas Recombination of up to 99%

Pure Lead Construction and Proprietary Elements

Designed for Float Service Standby Power Applications

Built in Accordance with IEC 60896-21/22:2004, UL1973 Listed (MH66728) and UL1989 Recognized (MH14533)

Certified by TUV NORD according to ISO 9001:2015





TPL Series

TPL121800 Datasheet

12V Front Terminal VRLA-AGM

Constant Current Discharge Characteristics Per Battery: Amperes (25°C, 77°F)												
F.V/Time	15MIN	30MIN	60MIN	90MIN	2HR	3HR	4HR	5HR	6HR	8HR	10HR	20HR
10.02V (1.67 VPC)	307	205	124	90.1	71.1	51.1	39.8	32.7	28.0	22.0	18.2	9.70
10.50V (1.75 VPC)	266	190	119	87.7	69.7	50.4	39.2	32.3	27.7	21.8	18.0	9.59
10.80V (1.80 VPC)	238	177	114	84.6	67.6	49.2	38.4	31.7	27.2	21.4	18.0	9.44

Constant Power Discharge Characteristics Per Battery: Watts (25°C, 77°F)												
F.V/Time	15MIN	30MIN	60MIN	90MIN	2HR	3HR	4HR	5HR	6HR	8HR	10HR	20HR
10.02V (1.67 VPC)	3208	2217	1386	1023	816	589	466	387	333	261	217	116
10.50V (1.75 VPC)	2879	2106	1354	1004	803	583	462	383	330	259	215	114
10.80V (1.80 VPC)	2624	1968	1302	975	782	569	454	377	324	255	211	113

Detail A Drawing(4:1)

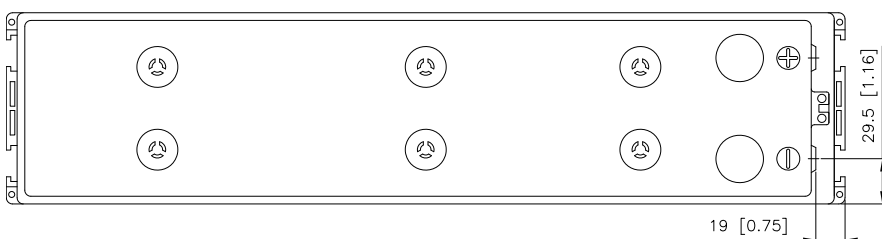

I2

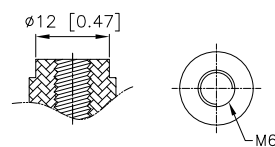

[M6 bolt]

