



HR Series

HR12120W Datasheet

12V Top Terminal VRLA-AGM

Specifications

Voltage (Vdc)	12
Watts Per Cell (30-Sec 1.67 VPC @ 25°C)	--
Watts Per Cell (5-Min 1.67 VPC @ 25°)	232.17
Watts Per Cell (15-Min 1.67 VPC @ 25°)	123
Max Charge Current (A)	12
Max Discharge Current (A)	225
Short Circuit Current (A)	928
Internal Resistance (mΩ)	8.2
Terminal Type	I1-Thread lead alloy recessed terminal to accept M5 bolt
Terminal Torque	30.4±6.1 Kgf·cm / 26.4±5.3 Lbf·in / 3.0±0.6 N·m
Container Material	ABS (UL 94-HB) & Flame Retardant (94-V0) available upon request
Weight (kg. / lb., Approx.)	10.2 / 20.48
Length (L) (mm / in)	166 / 6.54
Width (W) (mm / in)	125 / 4.92
Height (H) (mm / in)	175 / 6.89
Design Life	Up to 5 Years in Standby Service at 25°C. Eurobat (20°C): 3-5 Years Standard Commercial
Operating Temperature	Nominal: 25°C (77°F) Discharge: -15°C - 50°C (5°F-122°F) Charge/Storage: -15°C - 40°C (5°F - 104°F)
Float Charging Voltage	13.5 - 13.8 Vdc/battery 25°C (77°F)
Eq. Charging Voltage	14.4 - 15.0 Vdc/battery 25°C (77°F)
Self-Discharge	Less than 10% after 90 days, can be stored up to 6 months at 25°C (77°F); Fully recharging is required before usage, and charged sooner if stored at higher temperature than 25°C (77°F).



Valve Regulated Lead Acid (VRLA) Battery

Maintenance-Free, Absorbent Glass Mat (AGM) Technology for Efficient Gas Recombination of up to 99%

Pure Lead Construction and Proprietary Elements

Designed for High-Rate UPS, Float Service Standby Power Applications

Built in Accordance with IEC 61056-1/2:2012, UL1973 Listed (MH66728) and UL1989 Recognized (MH14533)

Certified by TUV NORD according to ISO 9001:2015





HR Series

HR12120W Datasheet

12V Top Terminal VRLA-AGM

Constant Current Discharge Characteristics Per Battery: Amperes (25°C, 77°F)

F.V/Time	2MIN	4MIN	5MIN	6MIN	8MIN	10MIN	15MIN	20MIN	30MIN	45MIN	60MIN	90MIN
10.02V (1.67 VPC)	153	135	124	115	100	88.9	67.0	53.6	39.7	29.6	24.0	16.6
10.50V (1.75 VPC)	132	117	108	101	88.9	80.2	62.0	50.4	37.8	28.3	23.1	16.2
10.80V (1.80 VPC)	117	105	97.2	91.2	81.3	73.3	58.3	48.0	36.0	27.1	22.2	15.8

Constant Power Discharge Characteristics Per Battery: Watts (25°C, 77°F)

F.V/Time	2MIN	4MIN	5MIN	6MIN	8MIN	10MIN	15MIN	20MIN	30MIN	45MIN	60MIN	90MIN
10.02V (1.67 VPC)	1608	1495	1393	1315	1119	975	738	600	453	341	279	194
10.50V (1.75 VPC)	1412	1306	1224	1161	1012	895	701	578	435	329	270	190
10.80V (1.80 VPC)	1273	1181	1113	1060	944	853	676	561	418	319	263	186

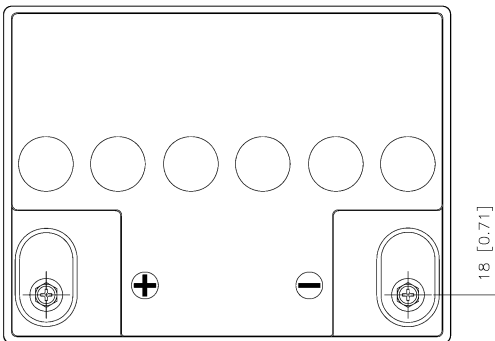

Detail A Drawing(3:1)

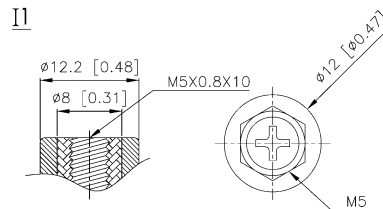

[M5 bolt]

